

Table of Contents

- | Welcome
- | About the property
- | Locally owned, with national reach
- | About the Margaret River Region

Welcome

Thank you for your interest in 32 Hudsbeth Way, Margaret River.

At First National Real Estate Margaret River, we strive to make the process of buying and selling property as simple and as straight-forward as possible.

I'm here to answer any questions you may have, so don't hesitate to get in contact.

I look forward to being of assistance in your search for your new property.

Yours sincerely,

First National Real Estate Margaret River

Craig Bamford
m. 0417 922 223

About the property



32 Hudsbeth Way, Margaret River

ENTERTAIN WITH ROOM TO SPARE

OFFERS ABOVE

2 Living Areas

Split System Air Conditioning

Reverse Cycle Air Conditioning

Study

Open Fire Place

Solar Panels

Remote Garage

Courtyard

Outdoor Entertaining

Shed

Workshop

Fully Fenced

Broadband Internet

Built In Robes

Dishwasher

All the hard work is done here, with quality fixtures and fittings throughout. Just back the truck up and move into` your new Margaret River home! This sprawling quality family residence is set amongst beautifully landscaped gardens on a big 750m2 lot in a delightful part of Margaret River and is going to impress and get a lot of interest. Indeed. The floorplan of this property is very clever, resulting in a home that just oozes easy living and comfort with oodles of space throughout.

Boasting multiple living areas including Media Room, impressive all weather Alfresco area, large open plan Kitchen/Living room, plus a separate Meals/Games room and another Lounge/Games area room for the kids. Add to that the Home Office, 4 bedrooms and 2 bathrooms and we have a very generously sized home that allows family and visitors alike to find space to escape or alternatively handle a crowd when you want to entertain.

Tucked away in the backyard is a big store shed under the extended huge Alfresco area. Ideal for storing a bunch of toys and garden equipment, and the Alfresco perfect to hang out with the gang and take cover in the winter if you are having a Barbecue. Parking is more than ample with a double lock up garage and a hard stand out the front, ideal to store a Caravan.

Make a time to view 32 Hudsbeth Way, Margaret River at your earliest convenience.
Offers Above \$975,000.

Floor Plan

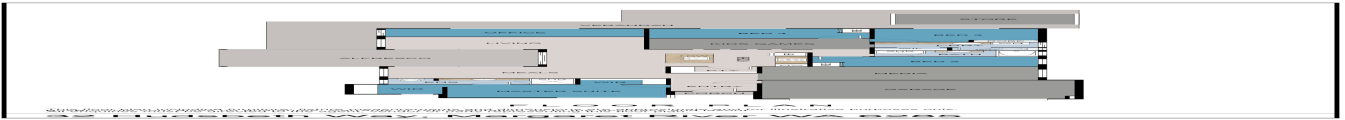

Title Documents

[Certificate of Title](#)

[Deposited Plan](#)

[Notifications](#)

Locally owned, with national reach

Margaret River Real Estate First National

Our company

Margaret River Real Estate First National is the first choice for the most advanced real estate services. We facilitate the sale, rental and management of land, residential, lifestyle, rural, industrial and commercial property in the heart of the South West Capes of Western Australia.

If you've been waiting for the ideal time to buy, sell or lease property...it's now. Let us show you why!

...and whether you choose Margaret River Real Estate First National to **buy, sell, rent or manage** your property, you can be sure we'll offer you carefully tailored solutions, the highest level of professionalism, expert local knowledge and the most experienced, highly regarded real estate agents and property managers in Margaret River.

Our aim is to get you better results, faster.

Your agent



Craig Bamford

m. 0417 922 223

craig@margaretriverrealestate.com.au

www.margaretriverrealestate.com.au

we put you first.

Margaret River WA 6285

Suburb Snapshots

Houses



Median House Price
\$996,000

12 months from 5-Apr-2025



Median Days on Market (House Sales)
46

12 months from 5-Apr-2025



Number of Houses Sold
119

12 months from 5-Apr-2025



Houses for Sale
39



Interested Buyers (House)
2332



Houses for Rent
16

Units



Median House Price

\$996,000

12 months from 5-Apr-2025



Median Days on Market (House Sales)

46

12 months from 5-Apr-2025



Number of Houses Sold

119

12 months from 5-Apr-2025



Houses for Sale

39



Interested Buyers (House)

2332



Houses for Rent

16

Powered by PropTrack



This information is supplied by First National Group of Independent Real Estate Agents Limited (ABN 63 005 942 192) on behalf of Proptack Pty Ltd (ABN 43 127 386 298).

For state-specific copyright and data disclaimers, see [Copyright and Legal Disclaimers about Property Data](#).

About the Margaret River Region

Explore our region



Margaret River is one of Western Australia's best tourist draw cards as it is world renowned for its winemaking, spectacular surf breaks and coastal scenery. Towering forests and picturesque vineyards provide scenic delight above ground whilst magnificent limestone caves form unique beauty underground. Located just 300 kilometres south of Perth, Margaret River is a holiday destination that is accessible to all and each year, some 1,500,000 overnight visitors embrace the diversity of this surfing, scenic wine growing region. The Augusta Margaret River region is enriched with wide range of cultures, characters and activities and supports a local population of approximately 15,000, making it one of the fastest growing shires in Australia.

Cowaramup

Gnarabup

Gracetown

**Hamelin
Bay**

Karridale

**Margaret
River**

Prevelly

**Rosa
Brook**

Witchcliffe